

TYPICAL SECTION
JUMBO NURSERY STONE NTS

CROSS SECTION
JUMBO NURSERY STONE NTS

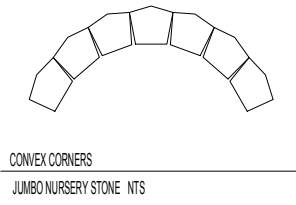
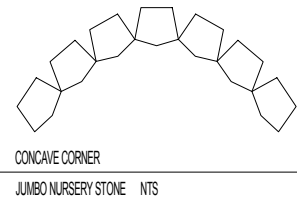

INSTALLATION GUIDE

JUMBO NURSERY STONE NTS

1. DETERMINE LINE AND HEIGHT OF WALL.
DIG TRENCH 4" TO 6" DEEP AND 24" WIDE

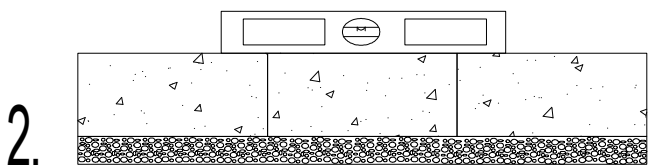

2. FILL TRENCH HALF FULL WITH LEVEL COMPACTED GRAVEL.
INSTALL FIRST LAYER OF BLOCK, LEVELING SIDE TO SIDE
AND BACK TO BACK
(CHIP OFF THE BACK LIP OF FIRST LAYER OF BLOCK)

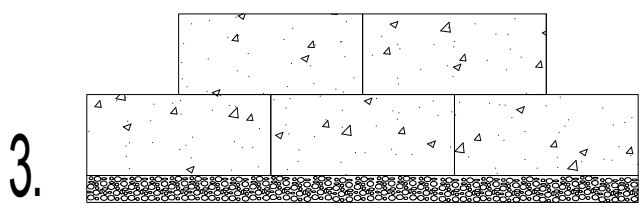

3. PLACE REMAINING BLOCKS ONTO WALL
IN A RUNNING BOND PATTERN

* CONTINUE LEVELING THE WALL AS YOU GO,
COMPACTING LOOSE DIRT BEHIND WALL.

* WALL REQUIRES A MINIMUM 4" OF GRAVEL BASE

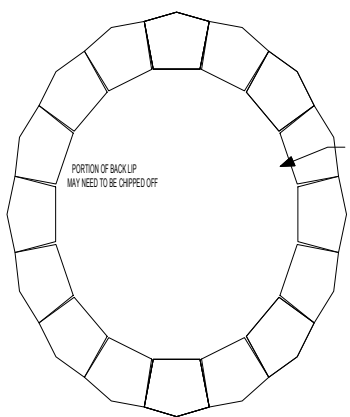

TREERING
JUMBO NURSERY STONE NTS

INSIDE
RADIUS:
30.27

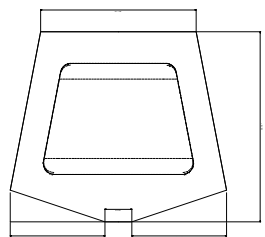
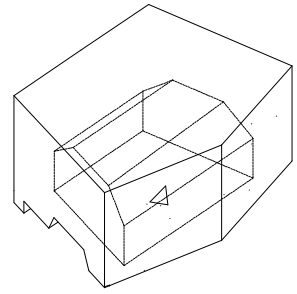

TOP VIEW

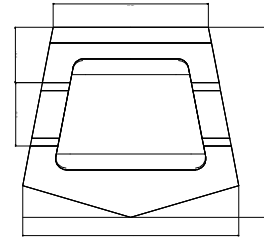

BOTTOM VIEW

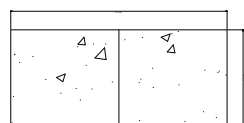

FRONT VIEW

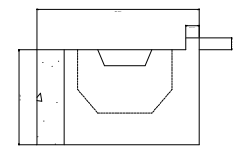

RIGHT VIEW



**WestBlock
Systems**
www.westblocksystems.com

**Jumbo
NurseryStone
System**

Block and Construction
Standard Details

DES. KLH SCALE: NTS
DR. KLH DATE: Dec 13, 2007

SHEET NO. 1 of 1